



RHA ALUMINUM EQUIPMENT ACCESS ROOF HATCH

Application

Acudor Equipment Access Roof Hatches are designed to provide convenient, economical access to the roof of a building where larger openings are required. This opening allows for equipment to be installed or removed from a building through the roof.

Features RHA

- Weather tight construction
- 12" high insulated curb
- Stainless Steel Hardware
- Convenient one-hand operation
- Supports 40lbs./sq. ft. live load

Optional Features RHA

- Painted and Anodized finishes
- Louvered Curbs
- Curb pitch corrected for sloped roof
- Higher curb heights for "green roof" applications
- Polycarbonate domes for daylighting
- Curb Mounted Units

RHA Specifications:

Cover: Double-skin construction ("in box type design") with 1" Polyiso (R-6) insulation and a continuous EPDM foam weather/draft seal gasket that is attached to the inside of cover to provide a flush, tight fit. Designed to support a live load of 40lbs./sq. ft., the cover is 1/8" thick aluminum with a 20 gauge aluminum inside liner.

Curb: 1/8" thick aluminum with 1" thick Polyiso (R-6) insulation at curb exterior. Curb is 12" high, with 3.375" wide bottom flange and pre-drilled mounting holes.

Hinge: Heavy duty Aluminum pintle hinges with 3/8" SS pin

Opening: Gas spring operators allow cover to open and close with ease. Stainless Steel Inside pull handle allows for easy control when closing cover.

Door Latch: Self latching, Stainless steel outside T handle with stainless steel inside lock and lever assembly. Unit also has inside and outside padlock provisions.

Finish: Mill finish.

RHA STANDARD SIZES (other sizes available)

Model	Curb ID W&L inches (mm)	Weight per Hatch lbs. (kg.)
A5656	48 x 48 (1219 x 1219)	115 (52.3)

For detailed specifications see submittal sheet

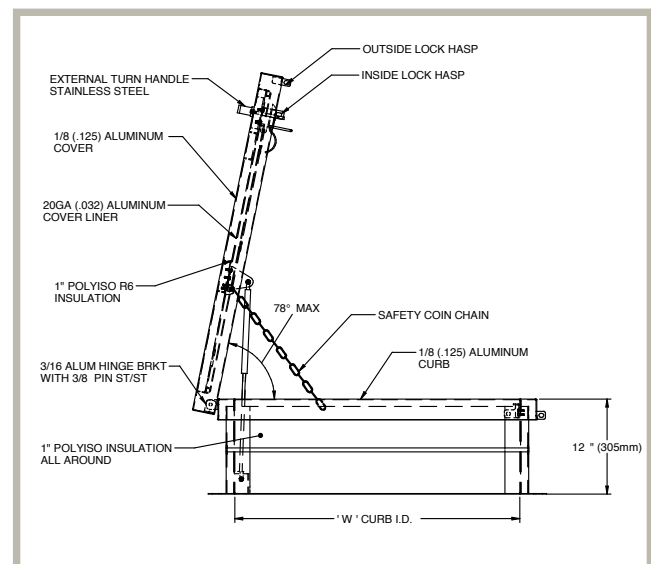
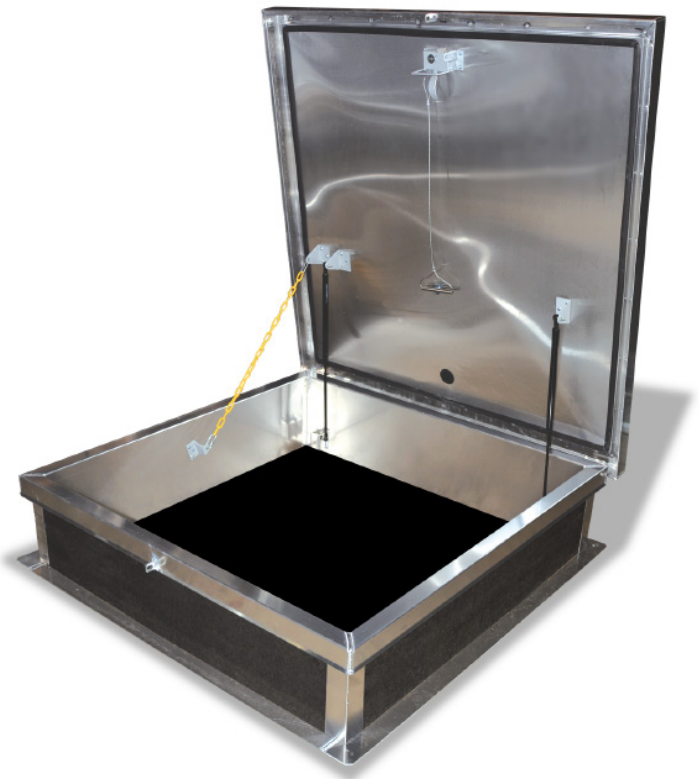



RHG EQUIPMENT ACCESS PRODUCT INFORMATION

RHG GALVANIZED EQUIPMENT ACCESS ROOF HATCH

Application

Acudor Equipment Access Roof Hatches are designed to provide convenient, economical access to the roof of a building where larger openings are required. This opening allows for equipment to be installed or removed from a building through the roof.

Features RHG

- Weather tight construction
- 12" high insulated curb
- G90 Galv. Steel
- Convenient one-hand operation
- Supports 40lbs./sq. ft. live load
- Stainless Steel Hardware

Optional Features RHG

- Stainless Steel cover, curb
- Louvered Curbs
- Curb pitch corrected for sloped roof
- Higher curb heights for "green roof" applications
- Polycarbonate domes for daylighting
- Curb Mounted Units

RHG Specifications:

Cover: Double-skin construction ("in box type design") with 1" Polyiso (R-6) insulation and a continuous EPDM foam weather/draft seal gasket that is attached to the inside of cover to provide a flush, tight fit. Designed to support a live load of 40lbs./sq. ft., the cover is 14 gauge galvanized steel with a 22 gauge galvanized steel inside liner.

Curb: 14 gauge galvanized steel with 1" thick Polyiso (R-6) insulation with Fiberglass liner at curb exterior. Curb is 12" high, with 3.375" wide bottom flange and pre-drilled mounting holes.

Hinge: Heavy duty galvanized steel pintle hinges with 3/8" SS pin

Opening: Gas spring operators allow cover to open and close with ease. Stainless Steel inside pull handle allows for easy control when closing cover.

Door Latch: Self latching, Stainless Steel outside T handle with stainless steel inside lock and lever assembly. Unit also has inside and outside padlock provisions.

Finish: Material is prepared with an iron phosphate wash, followed by a rust inhibiting primer, and then a baked on polyester enamel grey paint.

RHG STANDARD SIZES (other sizes available)

	Curb ID W&L	Weight per Hatch
Model	inches (mm)	lbs. (kg.)
G5656	48 x 48 (1219 x 1219)	185 (84.0)

For detailed specifications see submittal sheet

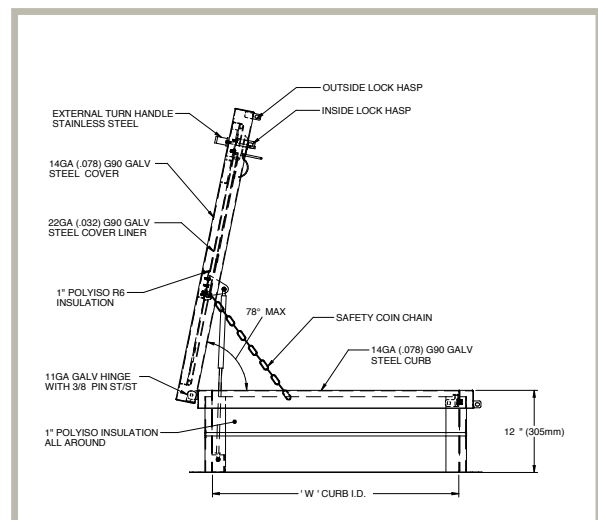

This document contains proprietary information which is the property of Acudor Products. It shall not be modified, copied, furnished, nor distributed (in whole or in part) without proper authorization. Copyright © 2020 Acudor Products.