

# Stucco and Plaster

Section: 09200

## ULTRA-LATH® Plastic Lath 1/8" Self Furred Non-Rusting

Plastic Component's Ultra Lath is perfect for one-coat stucco systems – in strips for drainage with cement board systems – and in sheets as an underlayment for tile, with and without radiant heating.

- 1/8" self-furred
- Available in sheets and rolls for overall coverage – and in strips
- High compressive strength
- Unaffected by salt, moisture, chemicals in tile-setting products, etc.
- Safe on hands, easy to cut and handle

### Sheets

Rustproof, self furred, damage-resistant ULTRA-LATH® sheets

Product Number	Description	Packaging	Qty per Pallet
PDM2796	ULTRA-LATH® Plastic Lath Sheets 27" x 96" (686 mm x 2.4 m)	10 sheets per bundle 180 sq.ft. (16.8 m <sup>2</sup> )	25 bundles per pallet 4500 sq.ft. (418 m <sup>2</sup> )

### Rolls

Rustproof, self furred, damage-resistant ULTRA-LATH® rolls

Product Number	Description	Packaging	Qty per Pallet
PDMR	ULTRA-LATH® Plastic Lath Rolls 27" x 100' roll (686 mm x 30.5 m)	225 sq.ft. (21 m <sup>2</sup> ) per roll	18 bundles per pallet 4050 sq.ft. (376.25 m <sup>2</sup> )

**Application:** For either exterior or interior vertical or horizontal application; should only be used for non-rated assemblies. The self-furring ridges provide exceptional keying and are applied towards the substrate. ULTRA-LATH® is impervious to sand and any harsh chemicals found in Portland-based stucco. IT WILL NEVER RUST. It may be installed over any code approved substrate.

**Specifications:** ULTRA-LATH® Plastic Lath shall be Plastic Components, Inc. # \_\_\_\_\_. It shall be used where specified by the design authority and installed per industry standards ASTM C1764 and C1861. Meets ASTM 330.84 and ASTM 330.84b.

### Strip Lath

Rustproof, self furred, damage-resistant ULTRA-LATH® strips

Product Number	Width	Length	Pieces per Box
PDM3	3" (76 mm)	96" (2.4 m)	50
PDM4	4" (102 mm)	96" (2.4 m)	50
PDM6	6" (152 mm)	96" (2.4 m)	50
PDM8	8" (203 mm)	96" (2.4 m)	50

We recommend Plastic Components trims for applications using ULTRA-LATH® plastic lath.

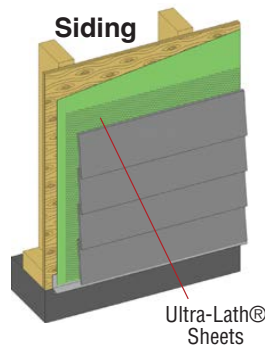
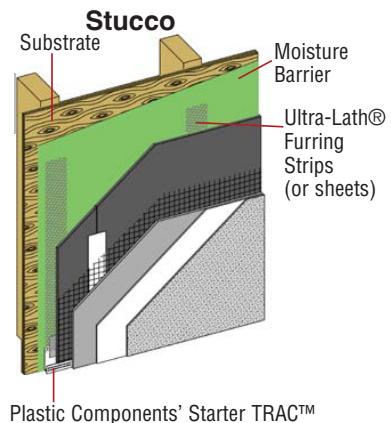

Great under tile



305.885.0561 ■ 800.327.7077  
www.plasticcomponents.com