

Stucco and Plaster

Section: 09200

Critter Control™ Casing Bead

Product Number	Dimension A Casing Bead w/weep holes	Back Flange Dimension B	Pieces in Box
1058-50WP	5/8" (16 mm) weeped ground	1/2" (13 mm)	50
1078-50WP	7/8" (22 mm) weeped ground	1/2" (13 mm)	50
1058-58WP	5/8" (16 mm) weeped ground	5/8" (16 mm)	50
1078-58WP	7/8" (22 mm) weeped ground	5/8" (16 mm)	50

10' (3 m) Lengths



Application:

Designed to terminate stucco at the base of a wall – serves as a cap for 1/2" (13 mm) or 5/8" (16 mm) sheathing. Weep holes in the ground drain moisture away from the base of the wall.

Specifications:

Critter Control™ Casing Bead shall be Plastic Components Inc. #105058WP series. All exterior accessories shall be PVC material conforming to ASTM standards D1784, C926, C1063, C1861 and D4216. They shall be used where specified by an design authority and installed per industry standards.

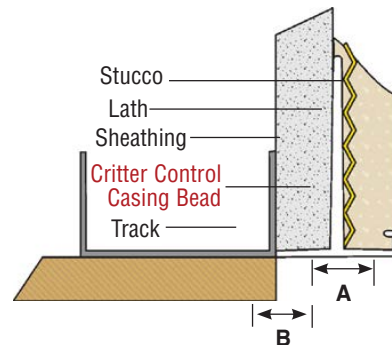

All butt joints, intersections and ends shall be caulked at the time of installation using an elastomeric sealant, such as Plastic Components' Ultra-Tech™ (PC-ULTW).



A-14